

CARNAHAN · PROCTOR · CROSS, INC.

CONSULTING ENGINEERS · SURVEYORS · PLANNERS

6101 WEST ATLANTIC BOULEVARD, MARGATE, FLORIDA 33063
PHONE: 954-972-3959 FAX: 954-972-4178

MAY 2002

990901B

JSH

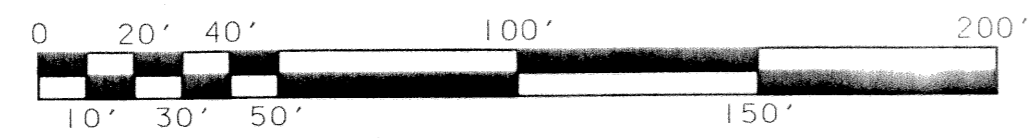
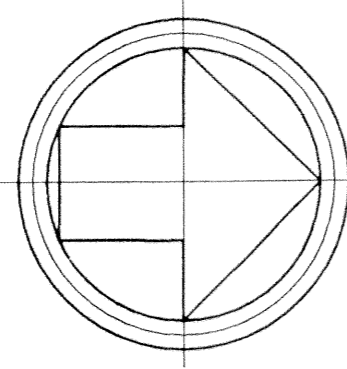

SCALE: 1"=40'

EVERGRENE PLAT TWO

A REPLAT OF A PORTION OF TRACT "A", "EVERGRENE" (P.B. 93, PGS. 117-119, P.B.C.R.)
CITY OF PALM BEACH GARDENS, PALM BEACH COUNTY, FLORIDA

SEE SHEET 21 OF 26

MATCH LINE

SHEET 20 OF 26

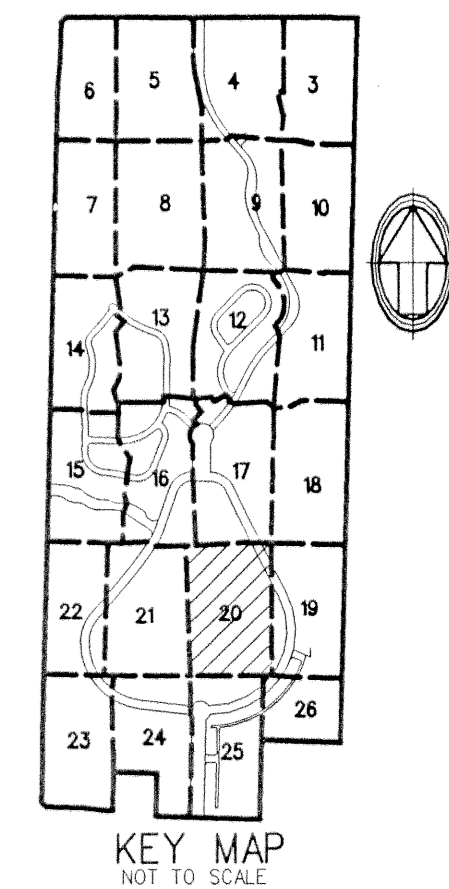

KEY MAP
NOT TO SCALE

WATER MANAGEMENT
TRACT WM-1
ALSO A WME IN
FAVOR OF NPBCID

LEGEND:

- SET PERMANENT REFERENCE MONUMENT (P.R.M.) • LB2936 UNLESS OTHERWISE NOTED
- PERMANENT CONTROL POINT
- ⊕ CENTERLINE
- ⊔ ARC LENGTH
- A.E. ANCHOR EASEMENT
- CH CHORD
- CHB CHORD BEARING
- D DELTA (CENTRAL ANGLE)
- D.B. DEED BOOK
- D.E. DRAINAGE EASEMENT
- FPL FLORIDA POWER & LIGHT COMPANY
- IEE INGRESS EGRESS EASEMENT
- LSE LIFT STATION EASEMENT
- NPBCID NORTHERN PALM BEACH COUNTY IMPROVEMENT DISTRICT
- N.R. NON-RADIAL
- D.R.B. OFFICIAL RECORDS BOOK
- P.C.D. PLANNED COMMUNITY DEVELOPMENT
- PG. PAGE
- P.B. PLAT BOOK
- P.B.C.R. PALM BEACH COUNTY RECORDS
- R RADIUS
- R.P.B. ROAD PLAT BOOK
- R/W RIGHT-OF-WAY
- SF SQUARE FEET
- SLE SEWER LINE EASEMENT
- SUA SEACOAST UTILITY AUTHORITY
- U.E. UTILITY EASEMENT
- WMAE WATER MANAGEMENT ACCESS EASEMENT
- WME WATER MANAGEMENT EASEMENT
- WLE WATER LINE EASEMENT

SEE SHEET 25 OF 26
MATCH LINE

35' 35'
S89° 52'40"E 2671.38
SOUTH LINE SECTION 25-41-42
NORTH LINE SECTION 38-41-42
70' N.P.B.C.I.D. D.E.
(O.R.B. 2914, PG.670)

SEE SHEET 17 OF 26
MATCH LINE

MATCH LINE

SEE SHEET 19 OF 26

FILE: r:\990901\ecad\pl\at2pp20.dgn
DATE: 16-May-02 16:26

SEE SHEET 26 OF 26

R=353.00' A=637.14' D=66° 00' 50"
R=38.50' A=1330.25' D
TRACT S-1

28' WATER MANAGEMENT
MAINTENANCE EASEMENT
S32° 13'16"E 322.15'

EVERGRENE PARKWAY
S28° 00'03"E 406.66'
S28° 00'03"E 406.07'

TRACT S-1

TRACT R-1

TRACT F-5

R=47.00'
D=51° 56' 59"
A=42.61'

S07° 56' 19" W 68.24'

S26° 06' 05" E 430.10'

429.12'

S26° 06' 05" E 428.15'